

Superior Standard for Hospital
Steam Sterilizer

SS360 / SS270

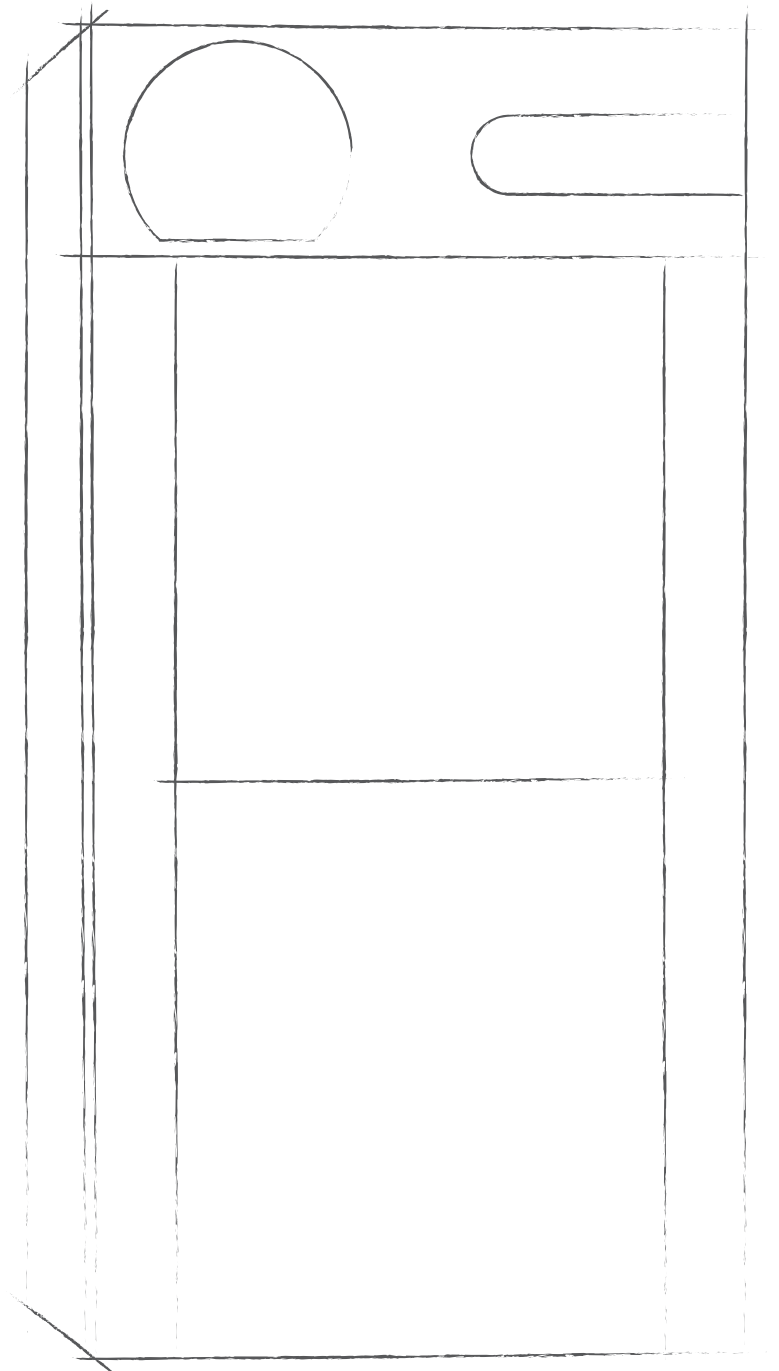

1 For User

Ergonomic Design

Full Color LCD Screen

Touch Screen user interface helps the user understand the status that the sterilizer is currently in e.g Date, Temperature, Cycle.

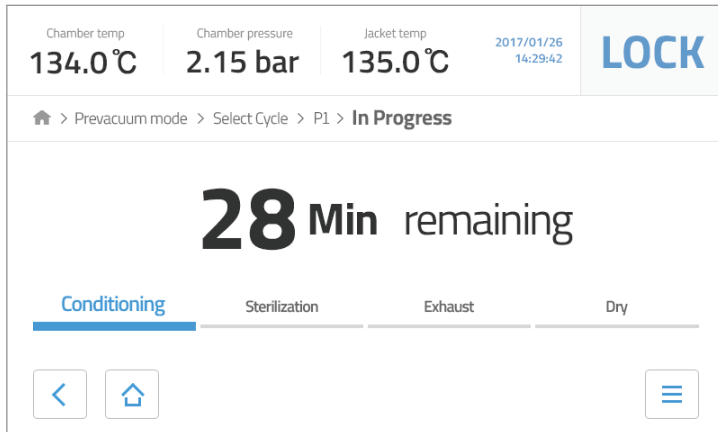

LED Lamp Indicator

Simply check current step.

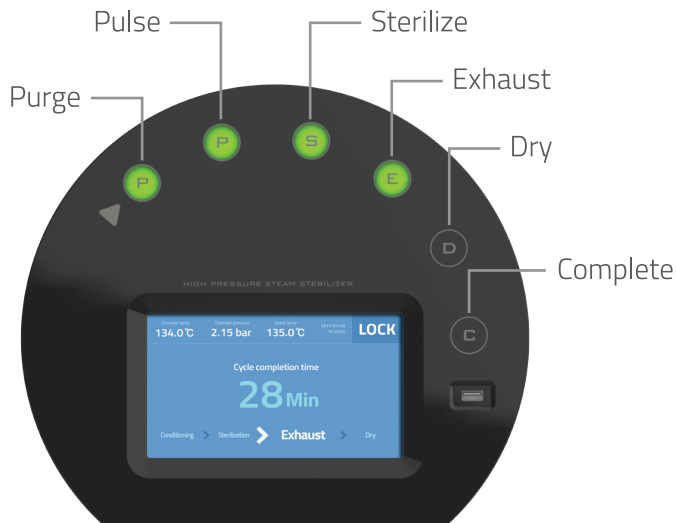

Green LED ON in normal status



Red LED ON in Error status





Operating Panel, Printer Located on Ergonomic Height



2 For User

Simple Operation

Touch Screen | Operate the cycle by simple touch



Various Mode | Have various mode (Pre-Vac, Gravity, User, Test) for user's needs

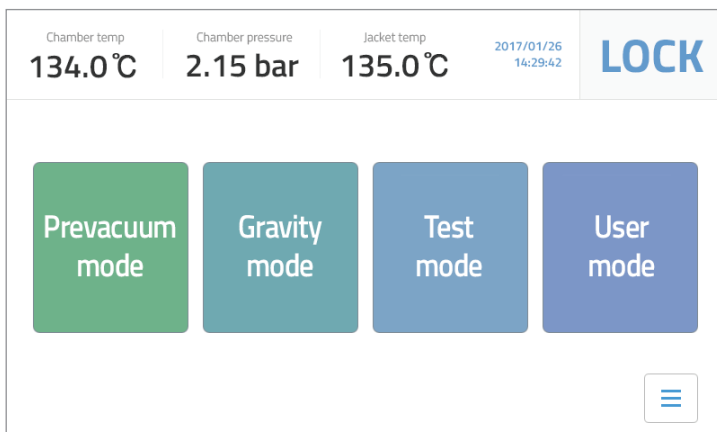

Auto Sliding Door | Open / close the door by simple button push



Open  Close





Loading System

Easy to move and safe Carriage / Loading car



3 For Workplace

Document Management

Saving Function | Save up to 50 cycles

Chamber temp **134.0°C** Chamber pressure **2.15 bar** Jacket temp **135.0°C** 2017/01/26 14:29:42 **LOCK**

Home > Menu > Cycle History

Cycle Start Time	Cycle End Time	Cycle Type	Cycle Result
2017-01-03 09:23:12	2017-01-03 09:23:12	P1	Complete
2016-12-27 11:23:43	2016-12-27 11:23:43	P2	Error 13, Error
2017-01-03 09:23:12	2017-01-03 09:23:12	G2	Complete
2016-12-27 11:23:43	2016-12-27 11:23:43	G3	Error 13, Error
2017-01-03 09:23:12	2017-01-03 09:23:12	G1	Complete

< Home PREVIOUS 1 / 3 NEXT ≡

Download | Save the cycle record in USB storage

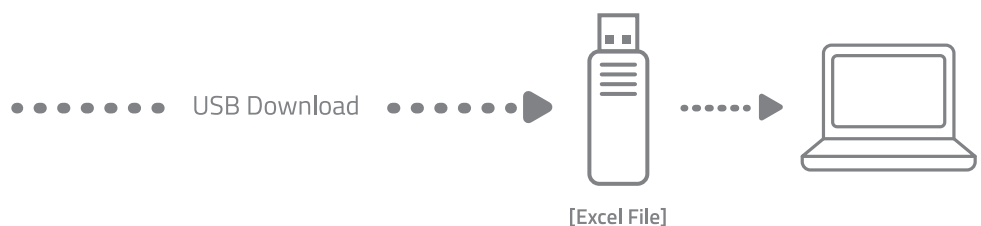
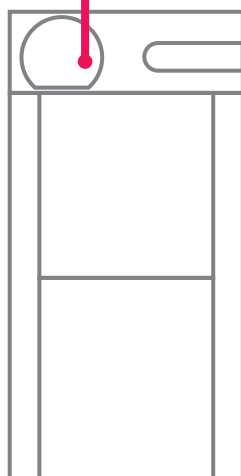
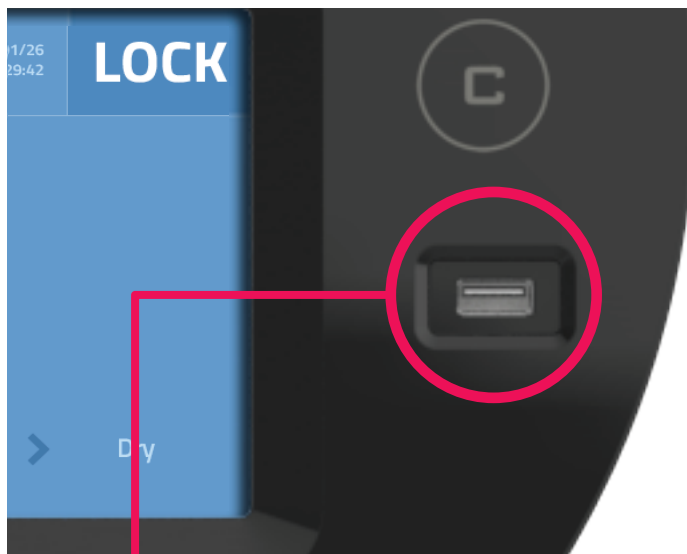

4 For Workplace

Maintenance

Service Mode | Running each step separately help to find problem

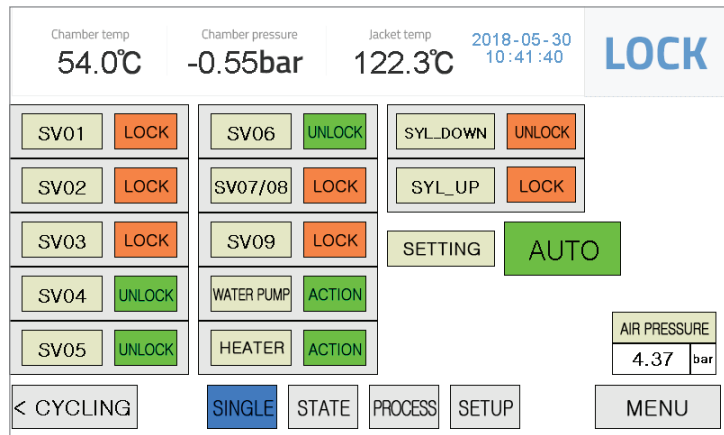

Self-Diagnostic System | Integrated safety program help to find the problem

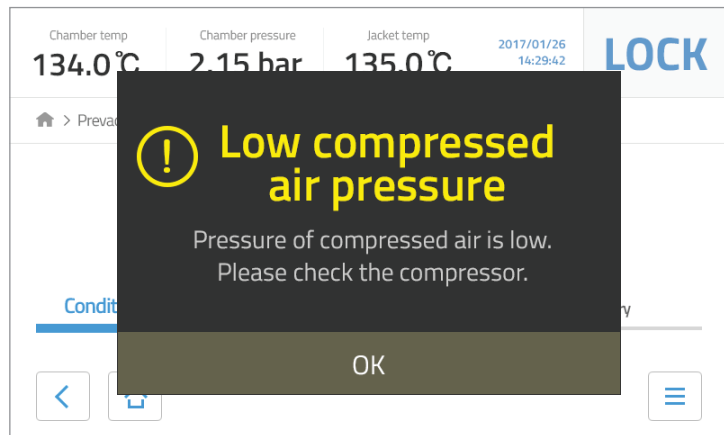

Safety Program | Automatic Exhaust Program Prevent any personal injuries from serious machine error

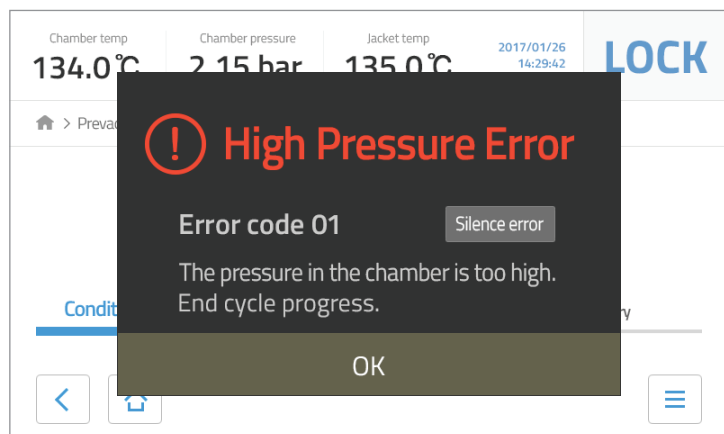

5 Technical Parameter Specifications

Model Name	JW-SS360	JW-SS270
Chamber	650(W) x 660(H) x 850(D) mm Square Type Chamber 360Liter (Capacity)	650(W) x 660(H) x 640(D) mm Square Type Chamber 270Liter (Capacity)
Overall Dimensions	900(W) x 1,850(H) x 1,350(D) mm	
Power Source	AC380V, 3-Phase, 4-Wire, 60Hz	
Air Removal	Vacuum , Gravity	
Display	Color Touch LCD Display	
Control Mode	Programmable Controller	
Printer	Thermal Printer	
Steam Generator	Built-in Steam Generator	
Door Type	Pneumatic Vertical Slide Type , Door Sealing Type	
Cycle Program	Pre-vacuum Mode , Gravity Mode , User Mode , Test Mode (Bowie-Dick, Leakage, Heating)	



Option

Loading Car	620(W) x 620(H) x 792(D) mm	620(W) x 620(H) x 582(D) mm
Carriage	510(W) x 1,120(H) x 1,180(D) mm	



JW Bio Science

9F, JW Tower, 2477 Nambusunhwan-Ro,
Seocho-Gu, Seoul 06725, Republic of Korea
Tel. +82-2-2109-7800 Fax +82-2-852-1984